



INTRODUCING THE NEW! RTG SERIES HIGH EFFICIENCY NON-CONDENSING TANKLESS

With the same proven performance both plumbers and homeowners trust, the Rheem® RTG Series High Efficiency Non-Condensing Tankless Water Heaters now offer a new modern design. These smaller, lighter units were designed with contractors in mind to make one-person installation and servicing even easier. Plus, enhanced features deliver continuous hot water and energy efficiency homeowners want.



**PROVEN
PERFORMANCE**
**NEW
MODERN
DESIGN**

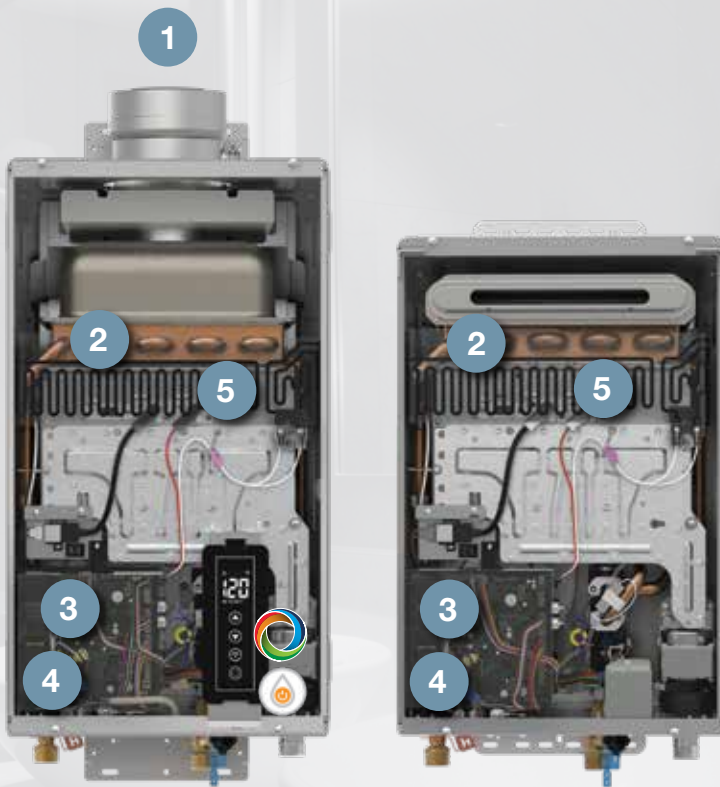

Indoor Model

Outdoor Model



These products meet a stringent set of our internally defined sustainability standards.¹

RHEEM RTG SERIES INDOOR & OUTDOOR

160K-199K BTU/h

Industry Leading 43' vent run capability for easy retrofit

Universal Venting Options – compatible with Metal Fab, Rainbow and UBBINK standard concentric venting

15-Year Warranty

 LeakGuard® with auto shut-off valve – Detects leaks and shuts off the flow of water²

 Integrated EcoNet® Smart Wi-Fi Monitoring Technology – Easy-to-use controls²

1 3"/5" Concentric inlet & exhaust

2 Copper heat exchanger

3 **Exclusive** Hot Start Programming™ – Minimizes cold water bursts

4 **Exclusive** water saving feature – Saves water

5 **Exclusive** overheat film wrap – Protects the home



Rheem.com/Tankless

In keeping with its policy of continuous progress & program improvement, Rheem reserves the right to make changes without notice.

¹Sustainability Standouts are Wi-Fi models only. ²Available on Select models only.